

*PENNSYLVANIA*

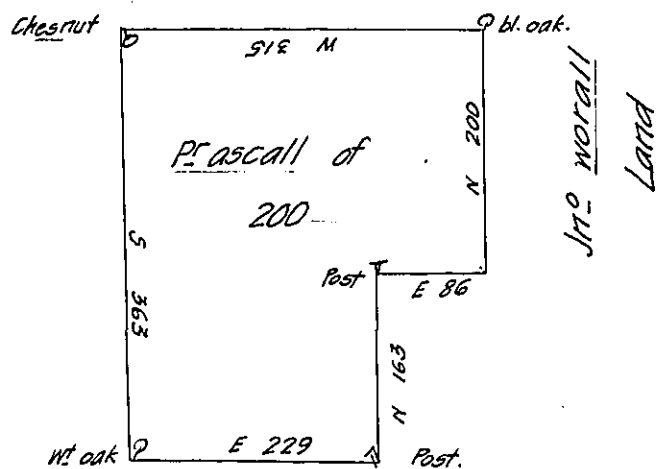

*- Cadmans Land*

By virtue of a warrant dated y<sup>e</sup> 23<sup>d</sup> <sup>6</sup>/<sub>m</sub> 1703 Layed out unto Joseph Brown attorney to susana Cadman a tract of land in the corner of another tract of 5<sup>d</sup>-Cadman's Land then by y<sup>e</sup> same Est 229 Pch to a bl. Post then north 163 Pch to a post thabl. Est 86 Pch to a post then by Jn<sup>o</sup> Worrell's Land north 200 Pch to a Corner Ches<sup>o</sup>bl. then west 315 Pch to a corner bl. oak. then south 363 Pch. to y<sup>e</sup> beginning Containing 625 acres Surv<sup>d</sup> y<sup>e</sup> 10<sup>th</sup> July 1704

*Henry Hollingsworth*

IN TESTIMONY that the above is a copy of the original remaining on file in the Department of Internal Affairs of Pennsylvania, made conformably to an Act of Assembly approved the 16th day of February, 1833, I have hereunto set my Hand and caused the Seal of said Department to be affixed at Harrisburg, this sixth day of April 1909

*Henry Howell*  
 Secretary of Internal Affairs.